

BIG PINE AREA

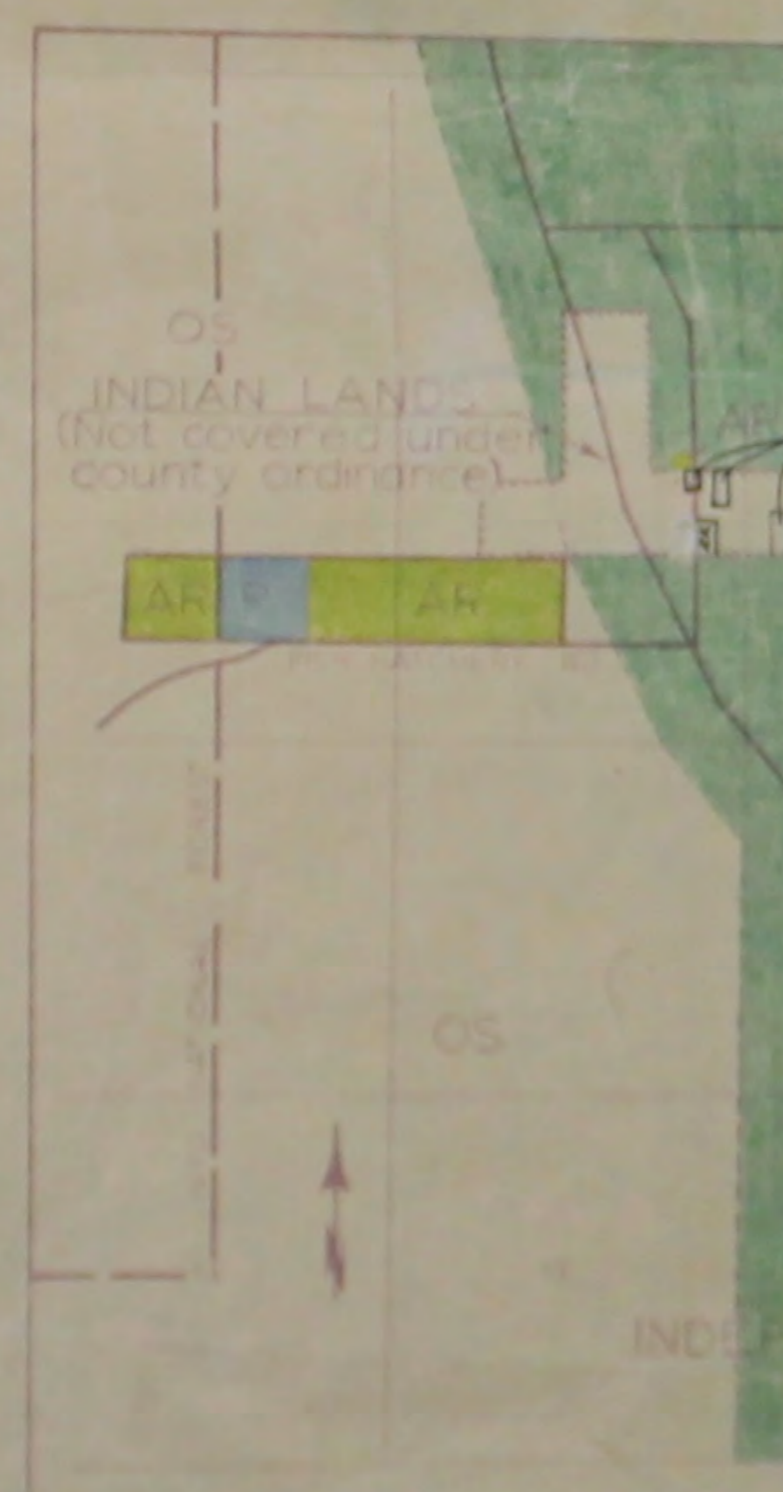

INDEPENDENCE AREA

### LEGEND

- ULC UNZONED AREAS LIMITED CONTROL
- OS OPEN SPACE
- AE AGRICULTURAL EXCLUSIVE
- ARR AGRICULTURAL RESIDENTIAL
- ARC AGRICULTURAL RECREATIONAL
- R1 ONE FAMILY RESIDENTIAL
- R2 MULTI-FAMILY RESIDENTIAL COMBINED RR&RHW
- RMH SINGLE RESIDENCE & MOBILE HOME
- RT ONE FAMILY MOBILE HOME RES.
- C1 GENERAL COMMERCIAL-RETAIL
- C2 HIGHWAY SERVICES & TOURIST COMM.
- M GENERAL INDUSTRIAL & EXTRACTIVE
- P PUBLIC
- SH SCENIC DRIVE
- C3 ADMINISTRATIVE & PROFESSIONAL OFFICES

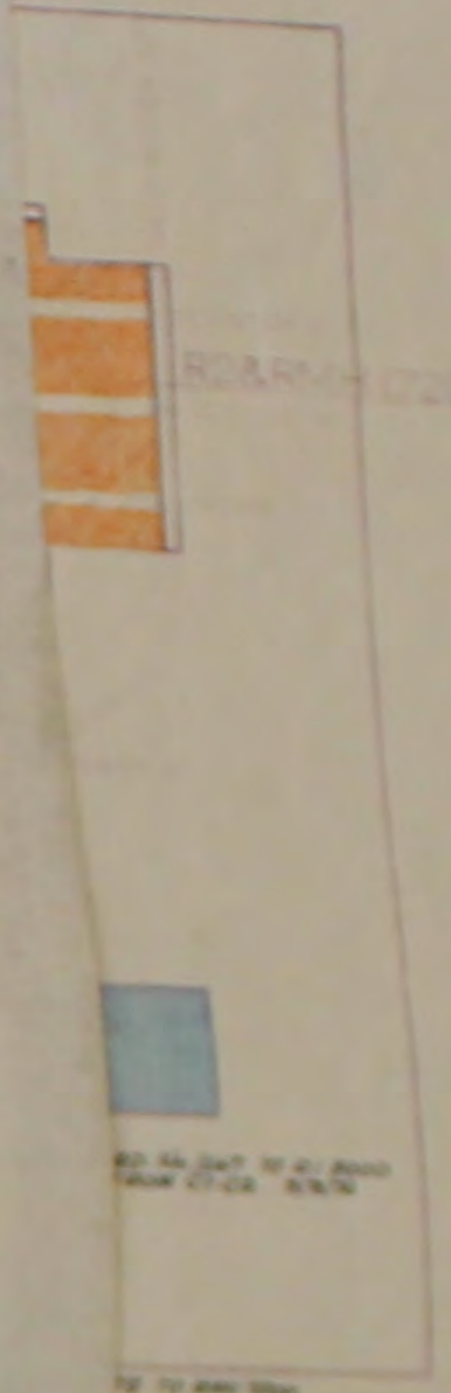

TOWN OF INDEPENDENCE

STATE OF CALIFORNIA  
 COUNTY OF ALBUQUERQUE  
 ZONING MAPS  
 Adopted by the County Board of Supervisors  
 May 20, 1978

INDEPENDENCE-BIG PINE AND SURROUNDING AREAS





**LEGEND**

**ROAD SYSTEMS**

- ARTERIAL
- COLLECTOR
- LOCAL

**STATE HIGHWAY ROUTE NO.**

- FAS 1234
- FEDERAL HIGHWAY NO.

**TRON ROUTES**

- STATE ROUTE
- COUNTY ROUTE

**BOUNDARIES**

- COUNTY BOUNDARY
- CITY BOUNDARY
- STATE BOUNDARY
- STATE CAPITAL
- COUNTY SEAT
- TOWN CENTER
- MILITARY AIRPORT
- RAILROAD STATION
- AIRPORT

STATE OF CALIFORNIA  
 TRANSPORTATION AGENCY  
 DEPARTMENT OF PUBLIC WORKS  
 DIVISION OF HIGHWAYS  
 IN COOPERATION WITH THE  
 U. S. DEPARTMENT OF TRANSPORTATION  
 FEDERAL HIGHWAY ADMINISTRATION  
 BUREAU OF PUBLIC ROADS  
 AND THE COUNTY

