

EXAMPLE CAMC0309604

RECORDING REQUESTED BY:
(Mail recording to:)

Name

ACE Cogeneration Company

Address

*P.O. Box 66
Trona, CA. 93592*



INYO, County Recorder
KAMMI FOOTE Co Recorder Office
DOC- 2015-0002086-00

Check Number 10901

Wednesday, AUG 12, 2015 09:50:15

MIC \$1.00:S21 \$3.00:REC \$14.00

SYS \$4.00:SST \$1.00:

Ttl Pd \$23.00

Rcpt # 0000110589

LS1/R1/1-4

FOR RECORDER'S USE

PLACER MINING CLAIM LOCATION NOTICE (CALIFORNIA)

To whom it may concern, please take notice that:

- Placer mining claim name is *Virginia #4*
- Date of location (date the proper location monument was erected and location notice posted in or on it) of this placer mining claim is *9 25 2014*
(month) (day) (year)
- Description of the discovery monument is as follows: *See Attachments*

4. Placer mining claim IS IN an area where there is a U.S. Public Land Survey and the description of the claim by legal subdivision including aliquot part (A.P.) of section (such as E1/2NE1/4NE1/4), Section (Sec.), Township (T.), Range (R.) and Meridian (Mer.), is as follows:

- A.P. *E1/2SW1/4E1/2W1/2*, Sec. *35*, T. *20S*, R. *42E*, Mer. *MDM*
- A.P. *SW1/4NW1/4W1/2SE1/4*, Sec. _____, T. _____, R. _____, Mer. _____
- A.P. _____, Sec. _____, T. _____, R. _____, Mer. _____
- A.P. _____, Sec. _____, T. _____, R. _____, Mer. _____

5. Placer mining claim IS NOT IN an area where there is a U.S. Public Land Survey, is marked by conspicuous and substantial monument at each claim corner, and is located by properly marked boundaries described below in reference to some natural object:

Natural object is (description) _____, and it is by compass direction _____, about _____ feet to the discovery monument. From the discovery monument it is by compass direction _____, about _____ feet to the NW corner post; from here it is by compass direction _____, about _____ feet to the NE corner post; from here it is by compass direction _____, about _____ feet to the SE corner post; from here it is by compass direction _____, about _____ feet to the SW corner post; from here it is by compass direction _____, about _____ feet to the NW corner post.



20150002086

CAMC0309604

6A. The undersigned locator(s) have defined the boundaries of the claim by erecting at each corner of the claim, or nearest accessible points thereto, a proper monument and each corner monument so erected bears or contains markings sufficient to appropriately designate the corner of the claim and the name of the claim.

6B. The date of monument erection and marking is 9 25 2014
(month) (day) (year)

6C. Description of each monument is as follow See Attachments

7. Attach to this Notice an appropriate U.S. Geologic Survey topographic map showing a sketch of the outline of the placer mining claim.

8. Placer mining claim is in INYO County.

9. Placer mining claim contain(s) 160 acres.

10. If your placer mining claim is in a power site withdrawal as determined from BLM Master Title Plat records, write "Filed under P.L. 359" on this line

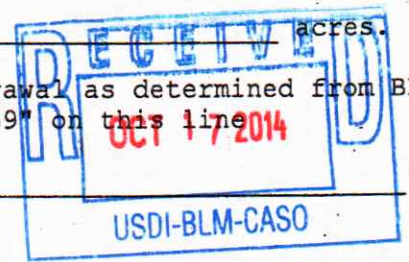

11. Locator(s) of this placer claim are: (Please Print)

Name(s)	Current Mailing or Residence Address
<u>Steven Haleman</u>	<u>P.O. Box 66 Trona, CA 93592</u>
<u>Ann Marie Taylor</u>	<u>P.O. Box 66 Trona, CA 93592</u>
<u>JON P. GRAVES</u>	<u>P.O. Box 66 Trona, CA 93592</u>
<u>Susan Hartson</u>	<u>P.O. Box 66 Trona, CA 93592</u>
<u>Jim Cox</u>	<u>P.O. Box 66 Trona CA 93592</u>
<u>Richard Points</u>	<u>P.O. Box 66 TRONA, CA 93592</u>
<u>TROY SEBLEY</u>	<u>P.O. Box 66 Trona, CA 93592</u>
<u>Steve Munn</u>	<u>P.O. Box 66 Trona CA 93592</u>

12. Signatures of locator(s):

<u>[Signature]</u>	Date <u>10/15/14</u>	<u>[Signature]</u>	Date <u>10-15-14</u>
<u>[Signature]</u>	Date <u>10/15/14</u>	<u>[Signature]</u>	Date <u>10-15-14</u>
<u>[Signature]</u>	Date <u>10/15/14</u>	<u>[Signature]</u>	Date <u>10/15/14</u>
<u>[Signature]</u>	Date <u>10/15/14</u>	<u>[Signature]</u>	Date <u>10/15/14</u>

20150002086

Attachment

LOCATION NOTICE

VOL 75 PAGE 45

PLACER 20012442

RECEIVED
BUR. OF LAND MGMT.

NOTICE IS HEREBY GIVEN. That the undersigned has on this 22nd day of ~~May~~ June 1985 located a placer mining claim situated in unknown Mining District, or in the vicinity of County of Inyo State of California, described as follows:

(a) IF UNSURVEYED LAND, GIVE DETAILED DESCRIPTION: Beginning at this monument of location, built of rock, at least 18 inches high, where this notice is posted. This monument bears North 70° West for the distance of 870 ft. from a point 825 ft. North of the SE corner of this claim. From the SE corner, the claim runs West 2640 ft. to the SW corner, thence North 2640 ft. to the NW corner, thence East 2640 ft. to the NE corner, thence South 2640 ft. to the SE corner.

(b) OR, IF SURVEYED LAND, GIVE LEGAL SUBDIVISIONS: When surveyed the ground covered by this claim will cover approximately the following ground:

The East 1/2 of the Sw 1/4 and the East 1/2 of the West 1/2 of the Sw 1/4, and the West 1/2 of the West 1/2 of the SE 1/4 of Sec 35,
of Section 35, Township 20 S, Range 42 E, MDM
Meridian

together with all water and timber appurtenant, allowed by law.

THIS CLAIM, consisting of 160 acres, shall be known as the "Virginia # 4"
Placer Mining Claim.

THIS CLAIM may be identified by its proximity to the following natural object or permanent monument, to-wit: The SE corner of this claim is approximately 1980 ft. West of the SW corner of Sec. 36, T.20.S., L2.E., N.D.M., which has been covered by a government survey.
James V Wiseman Locators Margaret Ousley

<u>Charles E Ousley</u>	LOCATORS	<u>Virginia Wiseman</u>
<u>Charles E Ousley</u>		<u>Virginia Wiseman</u>
<u>Kenneth B Ousley</u>		<u>Alma Blackman</u>
<u>Kenneth B Ousley</u>		<u>Alma Blackman</u>
<u>Bonathy Ousley</u>		<u>Lynn A Blackman</u>
<u>Frankly Ousley</u>		<u>Lynn A Blackman</u>

STATEMENT OF THE MARKING OF THE BOUNDARIES AND OF PERFORMANCE OF DISCOVERY WORK

NOTICE IS HEREBY GIVEN by the undersigned locators that in accordance with the provisions of the Mining Law:—

1. (If unsurveyed Land) There has been erected at the discovery point, and at each corner of said claim, these monuments: The discovery monument is of rock, at least 18 inches high. The SW corner is a rock monument at least 18 inches high marked SW CORNER VIRGINIA #4. The NW corner is a post marked NW CORNER VIRGINIA #4. The NE corner is a post marked NE CORNER VIRGINIA #4. The SE corner is a post marked SE CORNER VIRGINIA #4. All posts are made from 4" wood, extending at least 3 ft. above ground, and are mounted in a firm rock base.

within 90 days from date of location, the following discovery work:—

RECEIVED
JUN 26 1985

CANCELLED
459
MAY 16 1975

USDI-BLM-CA-SG LOCATORS: James V Wiseman, Charles E Ousley, Alma Blackman, Margaret Ousley

USDI-BLM-CASO RECEIVED
OCT 17 2014

Mining Location
45

20150002086

Attachment
CAMC 23068

20012442

25

CAMC 02787951206309604

USDI-BLM-CASO

OCT 17 2014

RECEIVED
APR 9 2014
CAMC 23068

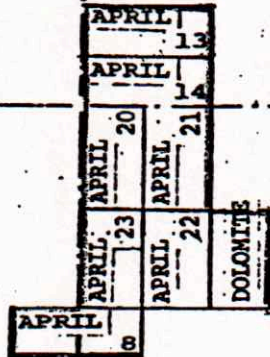
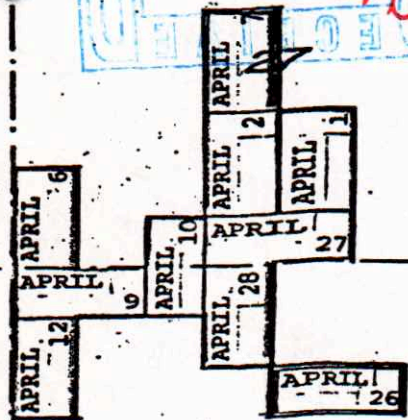

SCALE: 1 in = 2000 ft

VIRGINIA 4

VIRGINIA 5

VIRGINIA 2

VIRGINIA 1

RECEIVED
JUN 26 2014
USDI-BLM-CA-SO

LIME STONE 19
LIME STONE 18
LIME STONE 17
LIME STONE 16

VIRGINIA

LIME STONE 10
LIME STONE 11

LIME STONE 15
LIME STONE 14

LIME STONE 9
LIME STONE 3

LIME STONE 8
LIME STONE 1
LIME STONE 2

~~APRIL ET AL GROUPS~~
~~MERR-MCGEE CHEMICAL CORPORATION~~

SEC'S. 26, 27, 34 & 35 of Twp. 20 S.,
Rge. 42 E., SEC'S. 1 & 12 of Twp. 21 S
Rge. 42 E., SEC'S. 7 & 18 of
Twp. 21 S., Rge. 43 E., M.D.M.
INYO COUNTY, CALIFORNIA

R42E
R43E

Exhibit R