

CAMCO309635

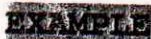

INYO County Recorder
KAMMI FOOTE Co Recorder Office
DOC- 2015-0002117-00
Check Number 10901
Wednesday, AUG 12, 2015 10:05:03
MIC \$1.00:S21 \$4.00:REC \$15.00
SYS \$5.00:SST \$1.00:
Ttl Pd \$26.00 Rcpt # 0000110651
LS1/R1/1-5

RECORDING REQUESTED BY:
(Mail recording to:)

Name

ACE Cogeneration Company

Address

P.O. Box 66

Trona, CA 93592

FOR RECORDER'S USE

PLACER MINING CLAIM LOCATION NOTICE (CALIFORNIA)

To whom it may concern, please take notice that:

- Placer mining claim name is Limestone #14
- Date of location (date the proper location monument was erected and location notice posted in or on it) of this placer mining claim is 9 25 2014
(month) (day) (year)
- Description of the discovery monument is as follows: See attachments

4. Placer mining claim IS IN an area where there is a U.S. Public Land Survey and the description of the claim by legal subdivision including aliquot part (A.P.) of section (such as E1/2NE1/4NE1/4), Section (Sec.), Township (T.), Range (R.) and Meridian (Mer.), is as follows:

A.P. NW1/4SE1/4 NE1/4, Sec. 13, T. 21S, R. 42E, Mer. MDM
 A.P. SW1/4NE1/4 NE1/4, Sec. _____, T. _____, R. _____, Mer. _____
 A.P. _____, Sec. _____, T. _____, R. _____, Mer. _____
 A.P. _____, Sec. _____, T. _____, R. _____, Mer. _____

5. Placer mining claim IS NOT IN an area where there is a U.S. Public Land Survey, is marked by conspicuous and substantial monument at each claim corner, and is located by properly marked boundaries described below in reference to some natural object:

Natural object is (description) _____, and it is by compass direction _____, about _____ feet to the discovery monument. From the discovery monument it is by compass direction _____, about _____ feet to the NW corner post; from here it is by compass direction _____, about _____ feet to the NE corner post; from here it is by compass direction _____, about _____ feet to the SE corner post; from here it is by compass direction _____, about _____ feet to the SW corner post; from here it is by compass direction _____, about _____ feet to the NW corner post.



CAMC0309635

20150002117

6A. The undersigned locator(s) have defined the boundaries of the claim by erecting at each corner of the claim, or nearest accessible points thereto, a proper monument and each corner monument so erected bears or contains markings sufficient to appropriately designate the corner of the claim and the name of the claim.

6B. The date of monument erection and marking is 9 25 2014
(month) (day) (year)

6C. Description of each monument is as follow See attachments

7. Attach to this Notice an appropriate U.S. Geologic Survey topographic map showing a sketch of the outline of the placer mining claim.

8. Placer mining claim is in Inyo County.

9. Placer mining claim contain(s) 20 acres.

10. If your placer mining claim is in a power site withdrawal as determined from BLM Master Title Plat records, write "Filed under P.L. 359" on this line

11. Locator(s) of this placer claim are: (Please Print)

Name(s)	Current Mailing or Residence Address
ACE Cogeneration Company	P.O. Box 66 Trona, CA 93592

12. Signatures of locator(s):

Steven Holman Date 10/15/14
as agent for:

ACE Cogeneration Company Date _____

_____ Date _____

_____ Date _____



~~LOCATION NOTICE~~ CAMC 23098

PLACER 20012426 RECEIVED BUREAU OF LAND MGMT.

MAR 16 10 00 AM '79

NOTICE IS HEREBY GIVEN: That the undersigned citizen... of the United States, over the age of twenty-one years in compliance with the requirements of Chapter VI, Title 32, of the Revised Statutes of the United States and the local customs, laws and regulations, has this day located and claimed the following described Placer Mining Grounds, viz:

The NW 1/4 of the SE 1/4 of the NE 1/4 and the SW 1/4 of the NE 1/4 of the NE 1/4 of Section 13, Township 21 South, Range 42 East, MDM.

together with all water and timber appurtenant, allowed by law.

THIS CLAIM consisting of 20 acres, shall be known as the "Limestone # 14" Mining Claim. It is situated in unknown

in Mining District, County of Inyo State of California, Section 13, Township 21 S, Range 42, E, MDM Meridian.

THIS CLAIM may be identified by its proximity to the following natural object or permanent monument, to-wit: Located by legal subdivision Monument built of rock, at least 18 inches in Height in which this notice of location is posted

LOCATED this 13th day of April 1955. The date of the discovery and posting of this notice is the 13th day of April 1955.

(Please Sign and also Print or Type Signatures)

LOCATORS

[Handwritten Signature]

STATEMENT OF THE MARKING OF THE BOUNDARIES AND OF PERFORMANCE OF DISCOVERY WORK

The markings of the boundaries of the aforesaid Claim as required by Sec. 2303 Public Resources Code, are designated and described as: Located by legal subdivision

Locators

[Handwritten Signature]



The locator has performed discovery work as required by Sec. 2304, Public Resources Code, as follows:

Excavated an open cut upon the claim and removed from the cut more than 7 cubic yards of material.



152 MAY 16 1955

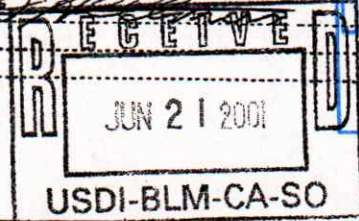

Exhibit A

20150002117

A Aachment
CAMC 23068

20012426

CAMC080810/CAMC0309635

26

25

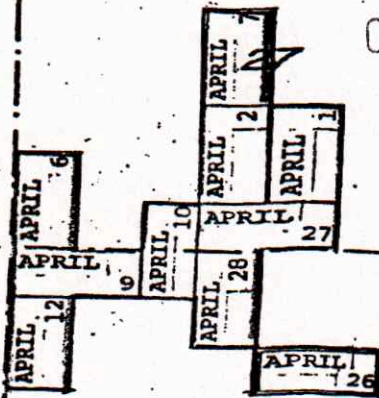

34

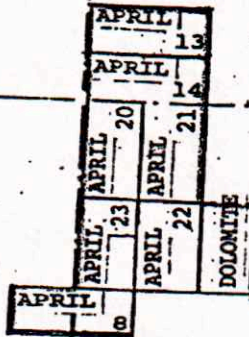

VIRGINIA 4

VIRGINIA 5

VIRGINIA 2

VIRGINIA 1

LIME STONE 19
LIME STONE 18
LIME STONE 17
LIME STONE 16
LIME STONE 15
LIME STONE 14
LIME STONE 13
LIME STONE 12
LIME STONE 11
LIME STONE 10
LIME STONE 9
LIME STONE 8
LIME STONE 7
LIME STONE 6
LIME STONE 5
LIME STONE 4
LIME STONE 3
LIME STONE 2
LIME STONE 1

VIRGINIA

LIME STONE 16

LIME STONE 15

LIME STONE 14

LIME STONE 13

LIME STONE 12

LIME STONE 11

LIME STONE 10

LIME STONE 9

LIME STONE 8

LIME STONE 7

LIME STONE 6

LIME STONE 5

LIME STONE 4

LIME STONE 3

LIME STONE 2

LIME STONE 1

SCALE: 1 in = 2000 ft

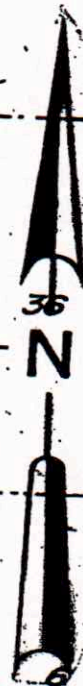

T20S
T21S

RECEIVED
JUN 21 2001
USDI-BLM-CA-SO

~~APRIL ET AL GROUPS~~
~~KERR-McGEE CHEMICAL CORPORATION~~

SEC'S. 26, 27, 34 & 35 of Twp. 20 S.
Rge. 42 E., SEC'S. 1 & 12 of Twp. 21 S.
Rge. 42 E., SEC'S. 7 & 18 of
Twp. 21 S., Rge. 43 E., M.D.M.
INYO COUNTY, CALIFORNIA

RECEIVED
OCT 17 2014
USDI-BLM-CASO

RECEIVED
OCT - 9 2014
18
USDI-BLM-CASO

R42E
R43E

Exhibit B

20150002117

A Hachera
CAMC 23068

20012427

CAMC0308105

26 CAMC0309633

25

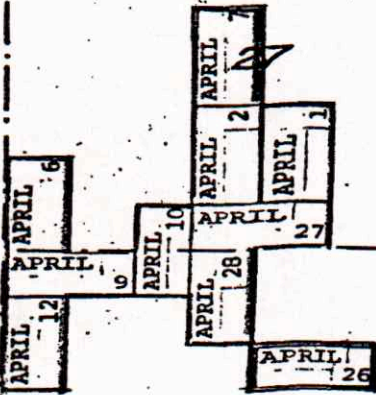

34

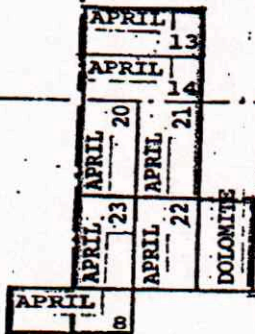

35

VIRGINIA 4

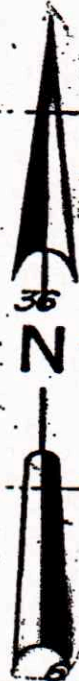

T20S
T21S

SCALE: 1 in = 2000 ft

2

VIRGINIA 5

VIRGINIA 2

11

12

VIRGINIA 1

7

RECEIVED
JUN 2 1944
USDI-BLM-CA-SO

LIME STONE 19
LIME STONE 18
LIME STONE 17
LIME STONE 16

VIRGINIA
LIME STONE 10
LIME STONE 11

LIME STONE 15
LIME STONE 14

LIME STONE 9

LIME STONE 8
LIME STONE 1
LIME STONE 3
LIME STONE 2

~~APRIL ET AL GROUPS~~
~~KERR-MCGEE CHEMICAL CORPORATION~~

SEC'S. 26, 27, 34 & 35 of Twp. 20 S.,
Rge. 42 E., SEC'S. 1 & 12 of Twp. 21 S.
Rge. 42 E., SEC'S. 7 & 18 of
Twp. 21 S., Rge. 43 E., M.D.M.
INYO COUNTY, CALIFORNIA

RECEIVED
OCT 17 2014
USDI-BLM-CASO

RECEIVED
OCT 18 2014
USDI-BLM-CASO
Exhibit B

R42E
R43E