



CAMCO309614

RECORDING REQUESTED BY:
(Mail recording to:)

Name

ACE Cogeneration Company

Address

P.O. Box 66

Trona, CA 93592



INYO, County Recorder
KAMMI FOOTE Co Recorder Office
DOC- 2015-0002096-00
Check Number 10901

Wednesday, AUG 12, 2015 09:55:11
MIC \$1.00:S21 \$3.00:REC \$14.00
SYS \$4.00:SST \$1.00:

Ttl Pd \$23.00

Rcpt # 0000110609
LS1/R1/1-4

FOR RECORDER'S USE

PLACER MINING CLAIM LOCATION NOTICE (CALIFORNIA)

To whom it may concern, please take notice that:

- Placer mining claim name is April # 8
- Date of location (date the proper location monument was erected and location notice posted in or on it) of this placer mining claim is 9 25 2014
(month) (day) (year)
- Description of the discovery monument is as follows: See attachments

4. Placer mining claim IS IN an area where there is a U.S. Public Land Survey and the description of the claim by legal subdivision including aliquot part (A.P.) of section (such as E1/2NE1/4NE1/4), Section (Sec.), Township (T.), Range (R.) and Meridian (Mer.), is as follows:

A.P. NW 1/4 NW 1/4 SW 1/4 & NE 1/4 NE 1/4 SE 1/4, Sec. 34, 35, T. 20S, R. 42E, Mer. MDM

A.P. _____, Sec. _____, T. _____, R. _____, Mer. _____

A.P. _____, Sec. _____, T. _____, R. _____, Mer. _____

A.P. _____, Sec. _____, T. _____, R. _____, Mer. _____

5. Placer mining claim IS NOT IN an area where there is a U.S. Public Land Survey, is marked by conspicuous and substantial monument at each claim corner, and is located by properly marked boundaries described below in reference to some natural object:

Natural object is (description) _____, and it is by compass direction _____, about _____ feet to the discovery monument. From the discovery monument it is by compass direction _____, about _____ feet to the NW corner post; from here it is by compass direction _____, about _____ feet to the NE corner post; from here it is by compass direction _____, about _____ feet to the SE corner post; from here it is by compass direction _____, about _____ feet to the SW corner post; from here it is by compass direction _____, about _____ feet to the NW corner post.



20150002096

CAMC0309614

6A. The undersigned locator(s) have defined the boundaries of the claim by erecting at each corner of the claim, or nearest accessible points thereto, a proper monument and each corner monument so erected bears or contains markings sufficient to appropriately designate the corner of the claim and the name of the claim.

6B. The date of monument erection and marking is 9 25 2014.
(month) (day) (year)

6C. Description of each monument is as follow See attachments

7. Attach to this Notice an appropriate U.S. Geologic Survey topographic map showing a sketch of the outline of the placer mining claim.

8. Placer mining claim is in Inyo County.

9. Placer mining claim contain(s) 20 acres.

10. If your placer mining claim is in a power site withdrawal as determined from BLM Master Title Plat records, write "Filed under P.L. 359" on this line

11. Locator(s) of this placer claim are: (Please Print)

Name(s)	Current Mailing or Residence Address
ACE Cogeneration Company	P.O. Box 66 Trona, CA 93592

12. Signatures of locator(s):

Steven Holman Date 10/15/14
as agent for:

ACE Cogeneration Company Date _____

Date _____

Date _____



LOCATION NOTICE

CAME 23072

PLACER 20012415

RECEIVED
OF LAND
OCT 17 2014

NOTICE IS HEREBY GIVEN. That the undersigned has this 25th day of October, 1955, located a placer mining claim situated in unknown Mining District, or in the vicinity of Inyo County of San Bernardino, State of California, described as follows:

(a) IF UNSURVEYED LAND, GIVE DETAILED DESCRIPTION: Beginning at this discovery monument, at least 18 inches high, built of rock, where is posted this notice. This monument bears S. 61° 15' West, 355 ft. from the NE corner of this claim. From the NE corner, thence South 660 ft. to the SE corner; thence West 1320 ft. to the SW corner; thence North 660 ft. to the NW corner; thence East 1320 ft. to the NE corner.

(b) OR, IF SURVEYED LAND, GIVE LEGAL SUBDIVISIONS: When surveyed, this ground will cover approx. the NW 1/4 of the NW 1/4 of the SW 1/4 of Sec. 35 and the NE 1/4 of the NE 1/4 of the SE 1/4 of Sec. 34

of Section 20, Township 20.S., Range 42.E., Meridian M.D.M.

together with all water and timber appurtenant, allowed by law.

THIS CLAIM, consisting of 20 acres, shall be known as the "APRIL #8"

Mining Claim.

THIS CLAIM may be identified by its proximity to the following natural object or permanent monument, to-wit: The NE corner of this claim is approx. 2640 ft. North and 4620 ft. West of the SE corner of Sec. 35, T.20.S., R.42.E., M.D.M., which has been established by a government survey.

LOCATORS

H. D. Hellmers

RECEIVED
OCT 17 2014
USDI-BLM-CASO

STATEMENT OF THE MARKING OF THE BOUNDARIES AND OF PERFORMANCE OF DISCOVERY WORK

NOTICE IS HEREBY GIVEN by the undersigned locator—that in accordance with the provisions of the Mining Law:

1. (If unsurveyed Land) There has been erected at the discovery point, and at each corner of said claim, these monument: The discovery monument is of rock, at least 18 inches high. All posts are made of 4x4" wood, extending at least 3 ft. above ground, and are mounted in a firm rock base. The NE corner is a post marked NE CORNER OF APRIL #8. The SE corner is a post marked SE CORNER OF APRIL #8. The SW corner is a post marked SW CORNER OF APRIL #8. The NW corner is a post marked NW CORNER OF APRIL #8.

2. The Locator has performed, within 90 days from date of location, the following discovery work: Excavated an open cut upon the claim and removed from the cut more than 7 cubic yards of material.

RECEIVED
OCT 16 2013
USDI-BLM-CASO

LOCATORS:

H. D. Hellmers

CANCELLED
OCT 19 2014
USDI-BLM-CASO

Request of
Richard P. O'Leary
JAN 17 1966

JAN 17 1966

VOL 81 of Mining Locations
RICHARD P. O'LEARY
E. W. S. Bell

JUN 21 2001

USDI-BLM-CASO

Exhibit A

20150002096

Attached
CAMC23068

CAMC0308093 CAMC0309614

20012415

25

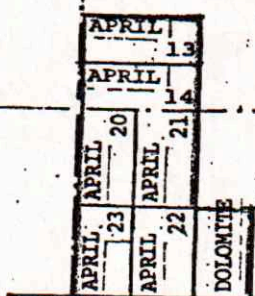
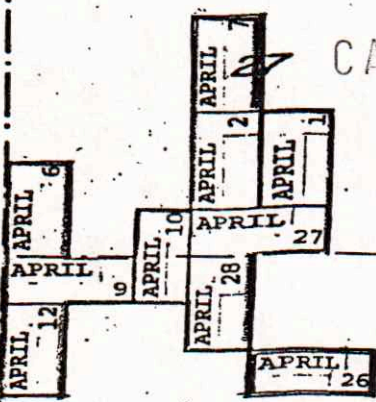

DOLANITE

34

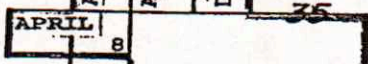

35

VIRGINIA 4



36

N

T20S
T21S

SCALE: 1 in = 2000 ft

RECEIVED
OCT 17 2014
USDI-BLM-CASO

2

VIRGINIA 5

VIRGINIA 2

11

12

VIRGINIA 1

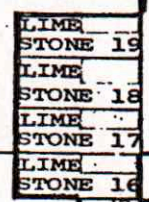

VIRGINIA

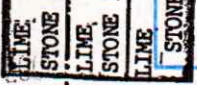
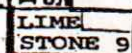
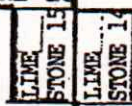
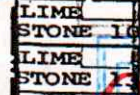

RECEIVED
DEC 16 2013
USDI-BLM-CASO

RECEIVED
NOV 9 2014
18
USDI-BLM-CASO

APRIL ET AL GROUPS
KERR-McGEE CHEMICAL CORPORATION

SEC'S. 26, 27, 34 & 35 of Twp. 20 S.,
Rge. 42 E., SEC'S. 1 & 12 of Twp. 21S
Rge. 42 E., SEC'S. 7 & 18 of
Twp. 21 S., Rge. 43 E., M.D.M.
INYO COUNTY, CALIFORNIA

13

JUN 21

R42E
R43E

Exhibit B