

INDEX OF SHEETS

1. TITLE AND LOCATION MAP
2. STATHAM HALL PLANS
3. PROGRESS HOUSE PLANS



COUNTY OF INYO
DEPARTMENT OF PUBLIC WORKS

PLANS FOR THE
COUNTY BUILDINGS ROOFING PROJECT
AT
PROGRESS HOUSE, BISHOP, CA AND STATHAM HALL, LONE PINE, CA

PROJECT. NO. ZP 16-054
AND ZP 16-055



GENERAL NOTES

1. THE CONTRACTOR SHALL IMMEDIATELY NOTIFY THE ENGINEER OF DISCREPANCIES BETWEEN THE INFORMATION SHOWN ON THESE DRAWINGS AND THE CONDITIONS EXISTING IN THE FIELD. THE CONTRACTOR SHALL COMPARE ALL DRAWINGS AND VERIFY THE FIGURES BEFORE LAYING OUT THE WORK AND WILL BE RESPONSIBLE FOR ANY ERRORS WHICH MIGHT HAVE BEEN AVOIDED THEREBY. IF THE CONTRACTOR FAILS TO NOTIFY THE ENGINEER IN A TIMELY MANNER OF ANY APPARENT ERROR OR OMISSION ON THE PLANS OR SPECIFICATIONS, THE CONTRACTOR SHALL BE RESPONSIBLE FOR CORRECTING WORK INCORRECTLY DONE AT THE CONTRACTOR'S OWN EXPENSE.
2. PAYMENT FOR WORK SHOWN ON THESE PLANS EITHER SPECIFIED OR INFERRED, BUT NOT IN THE BID PROPOSAL SHALL BE CONSIDERED AS INCLUDED IN OTHER ITEMS OF WORK.
3. ALL CONSTRUCTION AND MATERIALS SHALL CONFORM TO THESE PLANS AND SPECIFICATIONS, THE OCCUPATIONAL SAFETY AND HEALTH ADMINISTRATION STANDARDS, THE 2015 INTERNATIONAL BUILDING CODE (IBC), THE 2013 CALIFORNIA BUILDING CODE (CBC), THE 2013 UNIFORM BUILDING CODE (UBC), THE UNIFORM FIRE CODE (UFC), AND OTHER GOVERNING REGULATIONS.
4. ALL CONSTRUCTION WILL BE SUBJECT TO FINAL APPROVAL BY THE INYO COUNTY PUBLIC WORKS DEPARTMENT.
5. INSPECTION DURING CONSTRUCTION SHALL BE REQUIRED TO ENSURE CONSTRUCTION MATERIALS AND METHODS ARE IN ACCORDANCE WITH THE INYO COUNTY PUBLIC WORKS STANDARD SPECIFICATIONS AND THESE PLANS .
6. THE PROJECT SHALL BE BUILT PER PLAN. ALL FIELD CHANGES MUST BE PRE-APPROVED BY THE INYO COUNTY ENGINEER.
7. IN ACCORDANCE WITH THE GENERALLY ACCEPTED CONSTRUCTION PRACTICES, THE CONTRACTOR WILL BE SOLELY AND COMPLETELY RESPONSIBLE FOR THE CONDITIONS AT THE JOB SITE, INCLUDING SAFETY OF ALL PERSONS AND PROPERTY DURING PERFORMANCE OF THE WORK. THIS REQUIREMENT WILL APPLY CONTINUOUSLY AND NOT BE LIMITED TO NORMAL WORKING HOURS. THE DUTIES OF THE PROJECT CIVIL ENGINEER DO NOT INCLUDE REVIEW OF THE ADEQUACY OF THE CONTRACTOR'S SAFETY IN, ON OR NEAR THE CONSTRUCTION SITE.
8. PROJECT LOCATION: STATHAM HALL - 138 JACKSON STREET, LONE PINE, CA
PROGRESS HOUSE - 536 N. 2ND STREET, BISHOP, CA

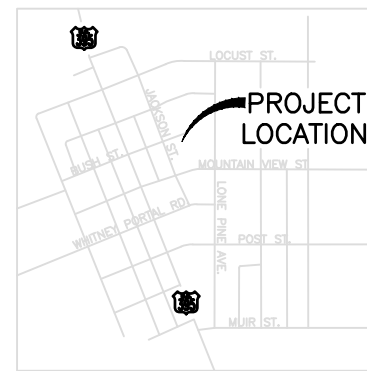

LONE PINE VICINITY MAP
NOT TO SCALE

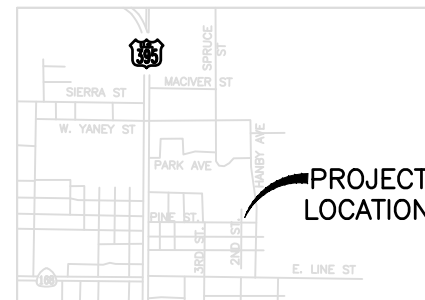

BISHOP VICINITY MAP
NOT TO SCALE

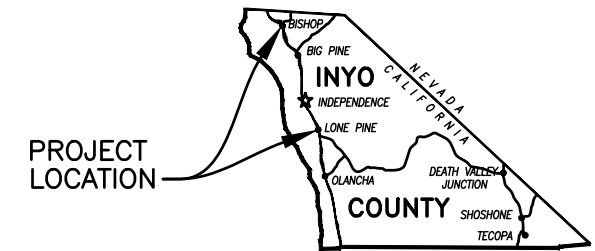

Clint G. Quilter

CLINT G. QUILTER, DIRECTOR
INYO COUNTY PUBLIC WORKS

8/7/17

DATE

Drawing Prepared by: INYO COUNTY PUBLIC WORKS 168 N. Edwards, P.O. Drawer Q Independence, CA 93526 (760) 878-0201		INYO COUNTY BUILDINGS ROOFING PROJECT	
		LONE PINE, CA AND BISHOP, CA	
Drawn by: TAD	Date: NOV. 2016	Checked By: ME	Date: NOV. 2016
Date: NOVEMBER 2016	Drawing Name: COUNTY BUILDINGS ROOFING PROJECT.dwg	SHEET 1 OF 3	

Z:\OPEN PROJECTS\Deferred Maintenance\Roofing Projects\Drawings\County Buildings Roofing Project.dwg

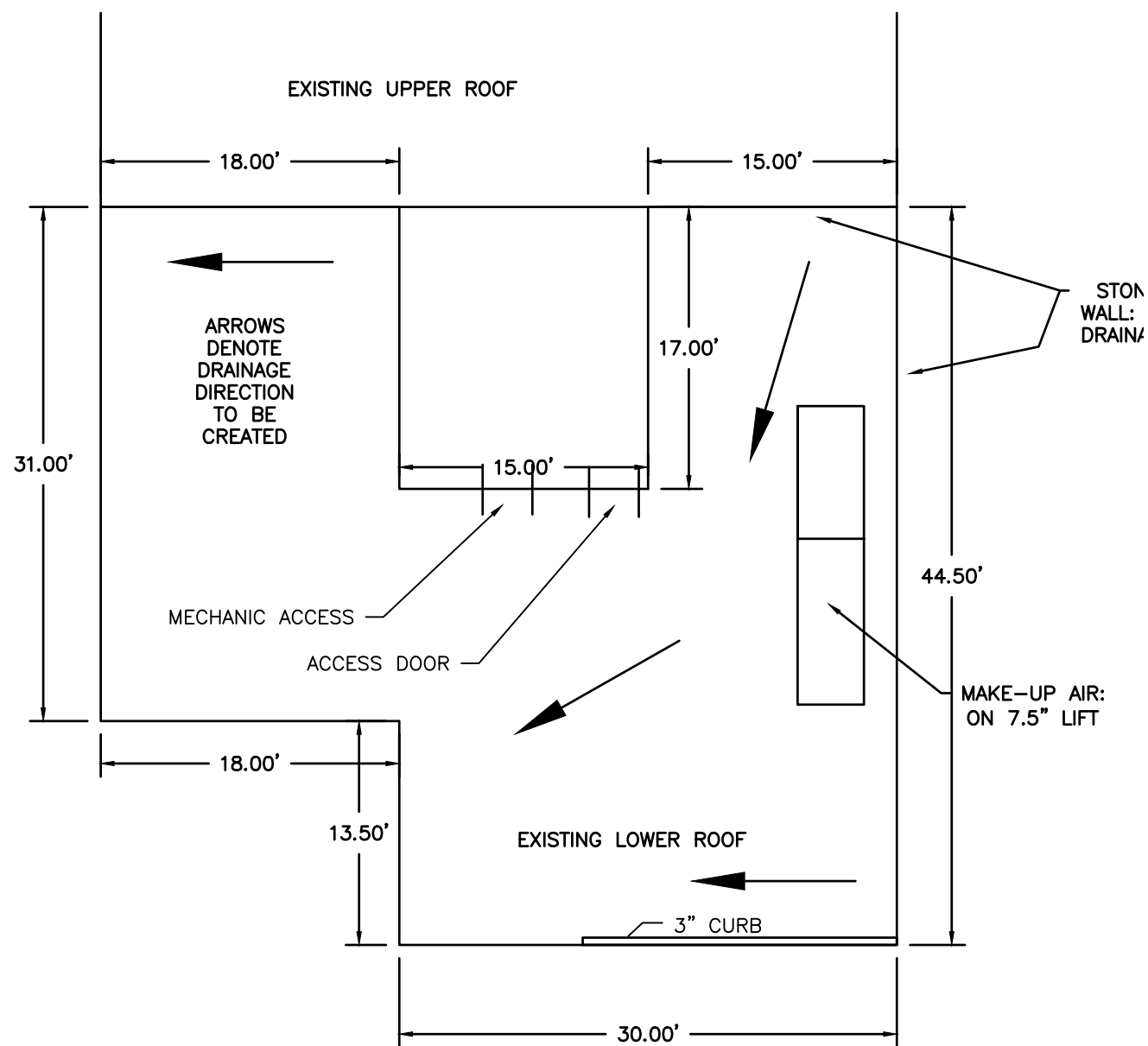

**STATHAM HALL
ROOF AERIAL VIEW**
SCALE: 1"=10'

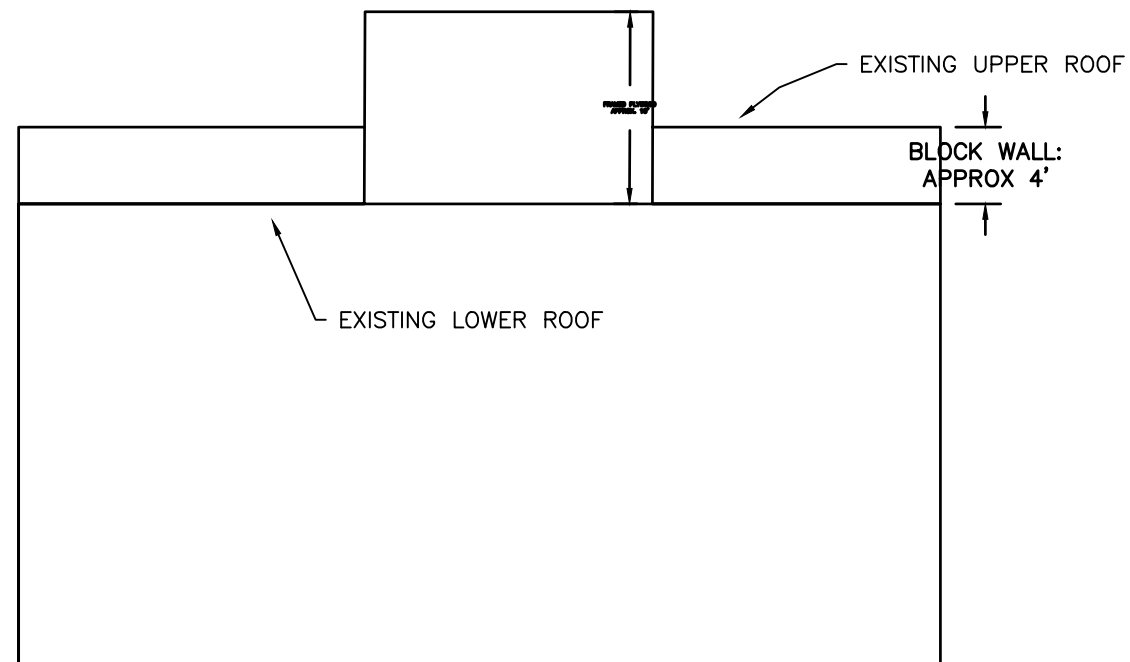

**STATHAM HALL
FRONT VIEW**
SCALE: 1"=10'

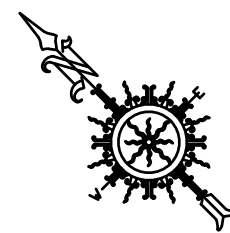

Drawing Prepared by: INYO COUNTY PUBLIC WORKS 168 N. Edwards, P.O. Drawer Q Independence, CA 93526 (760) 878-0201		INYO COUNTY BUILDINGS ROOFING PROJECT LONE PINE, CA AND BISHOP, CA	
Drawn by: ARH	Date: JUNE 2017	Checked By: ME	Date: JUNE 2017
Date: JUNE 2017		Drawing Name: COUNTY BUILDINGS ROOFING PROJECT.dwg	
			SHEET 2 OF 3

Z:\OPEN PROJECTS\Deferred Maintenance\Roofing Projects\Drawings\County Buildings Roofing Project.dwg

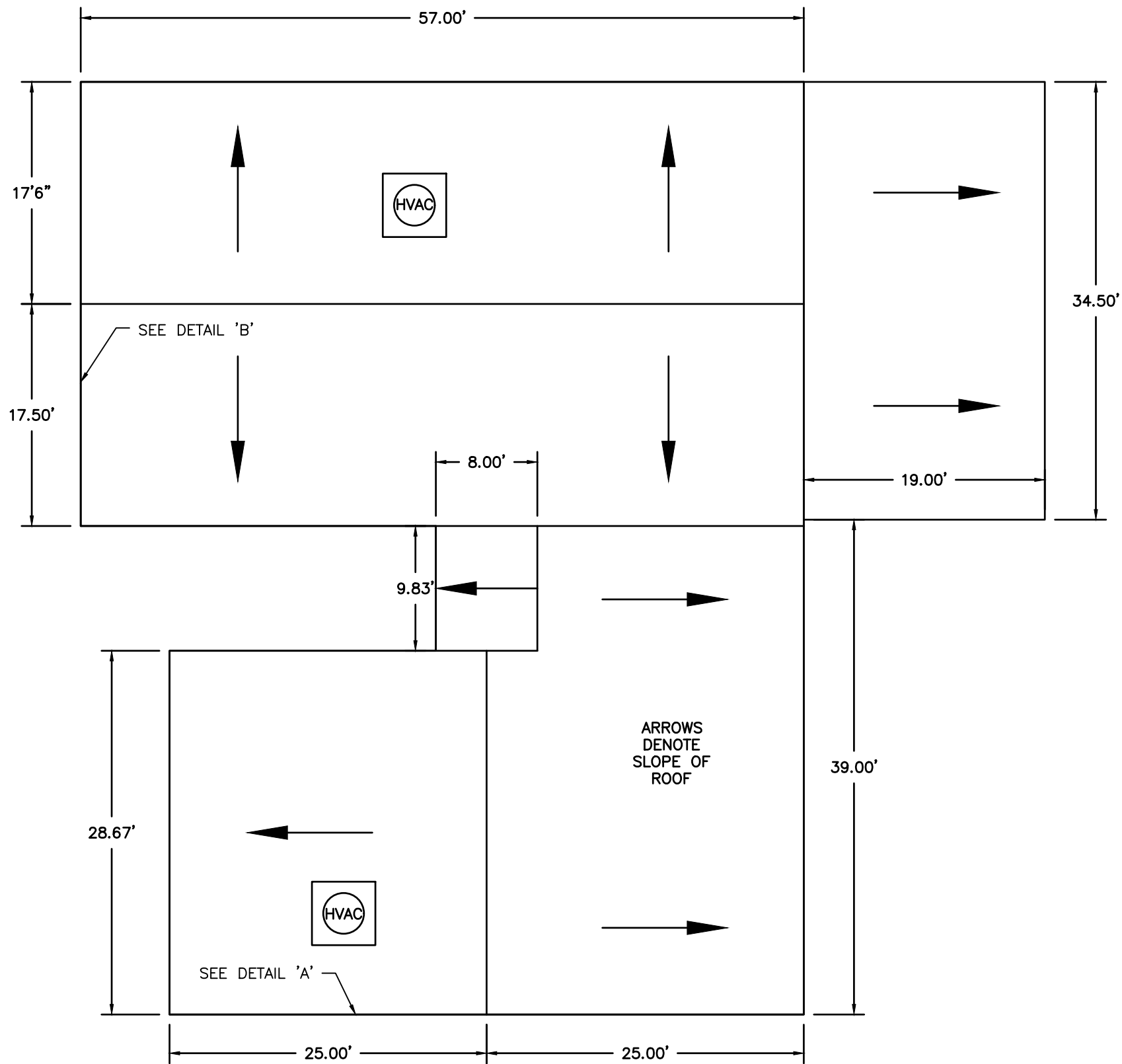

PROGRESS HOUSE
SCALE: 1"=10'

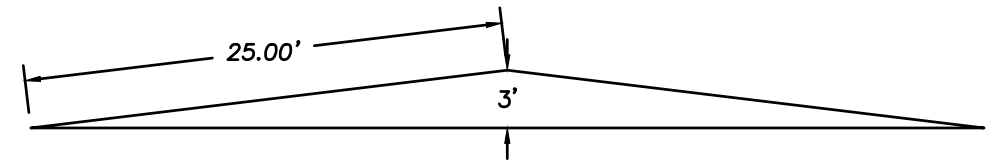
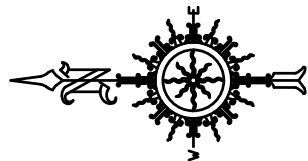

DETAIL A
SCALE: 1"=10'

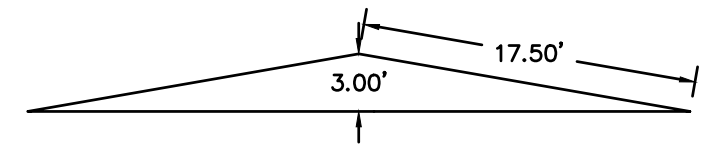

DETAIL B
SCALE: 1"=10'

Drawing Prepared by: INYO COUNTY PUBLIC WORKS 168 N. Edwards, P.O. Drawer Q Independence, CA 93526 (760) 878-0201		INYO COUNTY BUILDINGS ROOFING PROJECT LONE PINE, CA AND BISHOP, CA	
Drawn by: TAD	Date: NOV. 2016	Checked By: ME	Date: NOV. 2016
Date: NOVEMBER 2016	Drawing Name: COUNTY BUILDINGS ROOFING PROJECT.dwg	SHEET 3 OF 3	