

CAMC0309639

RECORDING REQUESTED BY:
(Mail recording to:)

Name
ACE Cogeneration Company
Address
P.O. Box 66
Trona, CA 93592

INYO County Recorder
KAMMI FOOTE Co Recorder Office
DOC- 2015-0002121-00
Check Number 10901
Wednesday, AUG 12, 2015 10:07:54
MIC \$1.00: S21 \$3.00: REC \$14.00
SYS \$4.00: SST \$1.00:
Ttl Pd \$23.00 Rcpt # 0000110659
LS1/R1/1-4

FOR RECORDER'S USE

PLACER MINING CLAIM LOCATION NOTICE (CALIFORNIA)

To whom it may concern, please take notice that:

- 1. Placer mining claim name is Limestone # 18
- 2. Date of location (date the proper location monument was erected and location notice posted in or on it) of this placer mining claim is 9 25 2014
(month) (day) (year)
- 3. Description of the discovery monument is as follows: See attachments

4. Placer mining claim IS IN an area where there is a U.S. Public Land Survey and the description of the claim by legal subdivision including aliquot part (A.P.) of section (such as E1/2NE1/4NE1/4), Section (Sec.), Township (T.), Range (R.) and Meridian (Mer.), is as follows:

A.P. N 1/2 SW 1/4 SE 1/4 Sec. 12 , T. 21S , R. 42E , Mer. MDM
 A.P. _____ , Sec. _____ , T. _____ , R. _____ , Mer. _____
 A.P. _____ , Sec. _____ , T. _____ , R. _____ , Mer. _____
 A.P. _____ , Sec. _____ , T. _____ , R. _____ , Mer. _____

5. Placer mining claim IS NOT IN an area where there is a U.S. Public Land Survey, is marked by conspicuous and substantial monument at each claim corner, and is located by properly marked boundaries described below in reference to some natural object:

Natural object is (description) _____ , and it is by compass direction _____ , about _____ feet to the discovery monument. From the discovery monument it is by compass direction _____ , about _____ feet to the NW corner post; from here it is by compass direction _____ , about _____ feet to the NE corner post; from here it is by compass direction _____ , about _____ feet to the SE corner post; from here it is by compass direction _____ , about _____ feet to the SW corner post; from here it is by compass direction _____ , about _____ feet to the NW corner post.

RECEIVED
OCT 17 2014
USDI-BLM-CASO

6A. The undersigned locator(s) have defined the boundaries of the claim by erecting at each corner of the claim, or nearest accessible points thereto, a proper monument and each corner monument so erected bears or contains markings sufficient to appropriately designate the corner of the claim and the name of the claim.

6B. The date of monument erection and marking is 9 25 2014.
(month) (day) (year)

6C. Description of each monument is as follow See attachments

7. Attach to this Notice an appropriate U.S. Geologic Survey topographic map showing a sketch of the outline of the placer mining claim.

8. Placer mining claim is in Inyo County.

9. Placer mining claim contain(s) 20 acres.

10. If your placer mining claim is in a power site withdrawal as determined from BLM Master Title Plat records, write "Filed under P.L. 359" on this line

11. Locator(s) of this placer claim are: (Please Print)

Name(s)	Current Mailing or Residence Address
ACE Cogeneration Company	P.O. Box 66 Trona, CA 93592

12. Signatures of locator(s):

[Signature] Date 10/15/14

as agent for:
ACE Cogeneration Company Date _____

Date _____

Date _____



20150002121

AHachm
CAME 23102

LOCATION NOTICE

03-002

PLACER

RECEIVED
BUR. OF LAND

20012410

NOTICE IS HEREBY GIVEN: That the undersigned has this 17th day of March 10 00 AM '75, located a placer mining claim situated in unknown Inyo Mining District, or in the vicinity of SACRAMENTO, County of San Bernardino, State of California, described as follows:

(a) IF UNSURVEYED LAND, GIVE DETAILED DESCRIPTION:

(b) OR, IF SURVEYED LAND, GIVE LEGAL SUBDIVISIONS:

The North 1/2 of the S.W. 1/4 of the S.E. 1/4

of Section 12, Township 21.S., Range 42.E., Meridian M.D.M.

together with all water and timber appurtenant, allowed by law.

THIS CLAIM, consisting of 20 acres, shall be known as LIMESTONE #18 Mining Claim.

THIS CLAIM may be identified by its proximity to the following natural object or permanent monument, to-wit: Located by legal subdivision

LOCATORS

H. D. Hellmers

RECEIVED
OCT 17 2014
USDI-BLM-CASO

STATEMENT OF THE MARKING OF THE BOUNDARIES AND OF PERFORMANCE OF DISCOVERY WORK

NOTICE IS HEREBY GIVEN by the undersigned locator—that in accordance with the provisions of the Mining Law:

1. (If unsurveyed Land) There has been erected at the discovery point, and at each corner of said claim, Located by legal subdivision (Posts or Markings)

2. The Locator has performed, within 90 days from date of location, the following discovery work. Excavated an open cut upon the claim and removed from the cut more than 7 cubic yards of material.

LOCATORS

USDI-BLM-CASO

RECEIVED
DEC 15 2013
156

RECEIVED
JUN 21 2001
USDI-BLM-CA-SO

MAY 1 0155
VOL 75 of Mining Locations
PAGE 42
RECORDS & OTHER RECORDS
Richard J. Miller
Los Angeles

Exhibit A

20150002121

A Hachmet

~~CAMC 23068~~

20012410

CAMC 0308088

26

CAMC 0309639

25

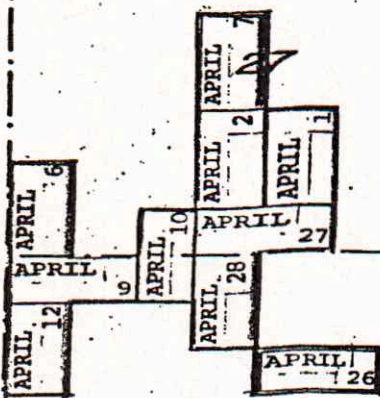

34

35

VIRGINIA 4

VIRGINIA 5

VIRGINIA 2

VIRGINIA 1

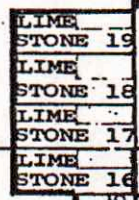

VIRGINIA

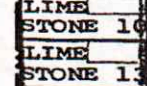

13

DEC 16 2013

USDI BLM CASO

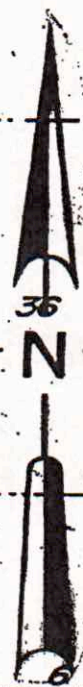

T20 S
T21 S

SCALE: 1 in = 2000 ft

RECEIVED
OCT 17 2014
USDI-BLM-CASO

RECEIVED
OCT 9 2014
USDI-BLM-CASO

RECEIVED
JUN 2 1 2014
USDI-BLM-CASO

~~APRIL ET AL GROUPS~~
~~KERR-McGEE CHEMICAL CORPORATION~~

SEC'S. 26, 27, 34 & 35 of Twp. 20 S.,
Rge. 42 E., SEC'S. 1 & 12 of Twp. 21 S.
Rge. 42 E., SEC'S. 7 & 18 of
Twp. 21 S., Rge. 43 E., M.D.M.
INYO COUNTY, CALIFORNIA

Exhibit B

R42E
R43E