

PLACER

CAMC0309610

RECORDING REQUESTED BY:  
(Mail recording to:)

Name

ACE Cogeneration Company

Address

P.O. Box 66

Trona, CA 93592



INYO, County Recorder

KAMMI FOOTE Co Recorder Office

DOC- 2015-0002092-00

Check Number 10901

Wednesday, AUG 12, 2015 09:53:23

MIC \$1.00:S21 \$3.00:REC \$14.00

SYS \$4.00:SST \$1.00:

Ttl Pd \$23.00

Rcpt # 0000110601

LS1/R1/1-4

FOR RECORDER'S USE

PLACER MINING CLAIM LOCATION NOTICE (CALIFORNIA)

To whom it may concern, please take notice that:

- 1. Placer mining claim name is April # 1
- 2. Date of location (date the proper location monument was erected and location notice posted in or on it) of this placer mining claim is 9 25 2014  
(month) (day) (year)
- 3. Description of the discovery monument is as follows: See attachments

4. Placer mining claim IS IN an area where there is a U.S. Public Land Survey and the description of the claim by legal subdivision including aliquot part (A.P.) of section (such as E1/2NE1/4NE1/4), Section (Sec.), Township (T.), Range (R.) and Meridian (Mer.), is as follows:

A.P. SW 1/4 NW 1/4 SE 1/4, Sec. 27, T. 20S, R. 42E, Mer. MDM  
 A.P. NW 1/4 SW 1/4 SE 1/4, Sec. \_\_\_\_\_, T. \_\_\_\_\_, R. \_\_\_\_\_, Mer. \_\_\_\_\_  
 A.P. \_\_\_\_\_, Sec. \_\_\_\_\_, T. \_\_\_\_\_, R. \_\_\_\_\_, Mer. \_\_\_\_\_  
 A.P. \_\_\_\_\_, Sec. \_\_\_\_\_, T. \_\_\_\_\_, R. \_\_\_\_\_, Mer. \_\_\_\_\_

5. Placer mining claim IS NOT IN an area where there is a U.S. Public Land Survey, is marked by conspicuous and substantial monument at each claim corner, and is located by properly marked boundaries described below in reference to some natural object:

Natural object is (description) \_\_\_\_\_, and it is by compass direction \_\_\_\_\_, about \_\_\_\_\_ feet to the discovery monument. From the discovery monument it is by compass direction \_\_\_\_\_, about \_\_\_\_\_ feet to the NW corner post; from here it is by compass direction \_\_\_\_\_, about \_\_\_\_\_ feet to the NE corner post; from here it is by compass direction \_\_\_\_\_, about \_\_\_\_\_ feet to the SE corner post; from here it is by compass direction \_\_\_\_\_, about \_\_\_\_\_ feet to the SW corner post; from here it is by compass direction \_\_\_\_\_, about \_\_\_\_\_ feet to the NW corner post.



CAMCO309610

20150002092

6A. The undersigned locator(s) have defined the boundaries of the claim by erecting at each corner of the claim, or nearest accessible points thereto, a proper monument and each corner monument so erected bears or contains markings sufficient to appropriately designate the corner of the claim and the name of the claim.

6B. The date of monument erection and marking is 9 25 2014.  
(month) (day) (year)

6C. Description of each monument is as follow See attachments

7. Attach to this Notice an appropriate U.S. Geologic Survey topographic map showing a sketch of the outline of the placer mining claim.

8. Placer mining claim is in Inyo County.

9. Placer mining claim contain(s) 20 acres.

10. If your placer mining claim is in a power site withdrawal as determined from BLM Master Title Plat records, write "Filed under P.L. 359" on this line

11. Locator(s) of this placer claim are: (Please Print)

Name(s)	Current Mailing or Residence Address
ACE Cogeneration Company	P.O. Box 66 Trona, CA 93592

12. Signatures of locator(s):

Steven Holman Date 10/15/14  
as agent for:

ACE Cogeneration Company Date \_\_\_\_\_

\_\_\_\_\_ Date \_\_\_\_\_

\_\_\_\_\_ Date \_\_\_\_\_



FILE THIS ORIGINAL NOTICE WITH THE APPROPRIATE COUNTY RECORDER (within 90 days of the date of location), AND FILE A DUPLICATE NOTICE (within the same 90 days) with the Bureau of Land Management, California State Office, 2800 Cottage Way Rm W1623, Sacramento, California 95825.

20150002092

Attached

LOCATION NOTICE

PLACER

CANCELLED  
20012421

RECEIVED  
NOTICE OF LAND ACMT.

NOTICE IS HEREBY GIVEN that the undersigned has this 2nd day of April 1955, located a placer mining claim situated in ~~unknown~~ Inyo Mining District, or in the vicinity of ~~SACRAMENTO, CALIFORNIA~~ Inyo County of San Bernardino, State of California, described as follows:

CANCELLED

(a) IF UNSURVEYED LAND, GIVE DETAILED DESCRIPTION: Beginning at this location monument, built of rock, at least 18 inches high, where is posted this notice; This monument bears South 27° 30' West, 505 ft. from the NE corner of this claim. From the NE corner, thence 1320 ft. South to the SE corner, thence West 660 ft. to the SW corner, thence North 1320 ft. to the NW corner, thence East 660 ft. to the NE corner.

(b) OR, IF SURVEYED LAND, GIVE LEGAL SUBDIVISIONS: I believe this ground covers approximately the SW 1/4 of the NW 1/4 of the SE 1/4 and the NW 1/4 of the SW 1/4 of the SE 1/4

of Section 27, Township 20.S., Range 42.E., Meridian M.D.M.

together with all water and timber appurtenant, allowed by law. THIS CLAIM, consisting of 20 acres, shall be known as the "APRIL #1" Mining Claim.

THIS CLAIM may be identified by its proximity to the following natural object or permanent monument, to-wit: The NE corner of this claim is approximately 3300 ft. South and 1930 ft. West of the SW corner of Sec. 23, T.20.S., R.42.E., M.D.M., which has been covered by a government survey.

LOCATORS

*H. D. Hellmers*  
H. D. Hellmers

RECEIVED  
OCT 17 2014  
USDI-BLM-CASO

STATEMENT OF THE MARKING OF THE BOUNDARIES AND OF PERFORMANCE OF DISCOVERY WORK

NOTICE IS HEREBY GIVEN by the undersigned locator that in accordance with the provisions of the Mining Law:

1. (If unsurveyed Land) There has been erected at the discovery point, and at each corner of said claim, these monuments: The discovery monument is of rock, at least 18 inches high. The NE corner is a post marked NE CORNER OF APRIL #1. (Posts or Markings) The NW corner is a post marked NW CORNER OF APRIL #1. The SW corner is a rock monument at least 18 inches high marked SW CORNER OF APRIL #1. The SE corner is a rock monument at least 18 inches high marked SE CORNER OF APRIL #1. All posts are made from 4x4 wood, extending at least 3 ft. above ground, and are mounted in a firm rock base.

2. The Locator has performed, within 90 days from date of location, the following discovery work: Excavated an open cut upon the claim and removed from the cut more than 7 cubic yards of material.

DEC 16 2013

LOCATORS

RECEIVED  
JUN 21 2001  
USDI-BLM-CA-SO

RECEIVED  
CANCELLED  
USDI-BLM-CASO

MAY 16 1955  
Mining Locations  
RECORDED  
NICHARD F. GILES, Recorder  
Richard F. Giles

Exhibit A

Attachment

20150002092

~~CA 03068~~

20012421

CA 0309610

25



36

N

T20S  
T21S

SCALE: 1 in = 2000 ft

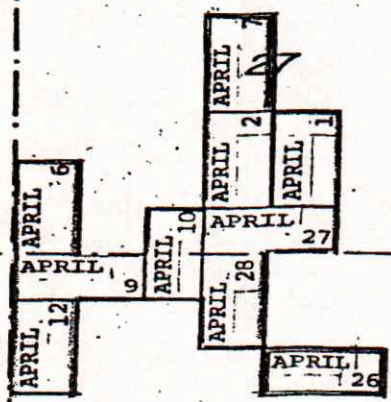

34

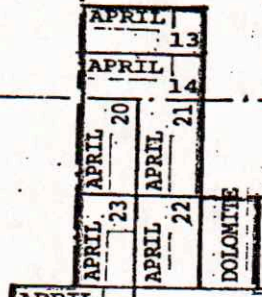

35

VIRGINIA 4

VIRGINIA 5

VIRGINIA 2

2

11

12

VIRGINIA 1

RECEIVED  
JUN 21 2001  
USDI-BLM-CA-SO

LIME STONE 19  
LIME STONE 18  
LIME STONE 17  
LIME STONE 16  
LIME STONE 15  
LIME STONE 14  
LIME STONE 13  
LIME STONE 12  
LIME STONE 11  
LIME STONE 10  
LIME STONE 9  
LIME STONE 8

VIRGINIA  
LIME STONE 16  
LIME STONE 15  
LIME STONE 14  
LIME STONE 13  
LIME STONE 12  
LIME STONE 11  
LIME STONE 10  
LIME STONE 9  
LIME STONE 8

RECEIVED  
DEC 16 2013  
USDI-BLM-CASO

REC  
OCT 17 2014  
USDI-BLM-CASO

RECEIVED  
NOV 9 2014  
18  
USDI-BLM-CASO

APRIL ET AL GROUPS  
~~KERR-McGEE CHEMICAL CORPORATION~~  
SEC'S. 26, 27, 34 & 35 of Twp. 20 S.,  
Rge. 42 E., SEC'S. 1 & 12 of Twp. 21S  
Rge. 42 E., SEC'S. 7 & 18 of  
Twp. 21 S., Rge. 43 E., M.D.M.  
INYO COUNTY, CALIFORNIA

R42E  
R43E

Exhibit B